

REVISIONS					
ZONE	REV.	ECO#	DESCRIPTION	DATE	APPROVED
-	A		CREATED NEW PART # W/ MODIFIED TIE ROD END POSITION	6-15	JB

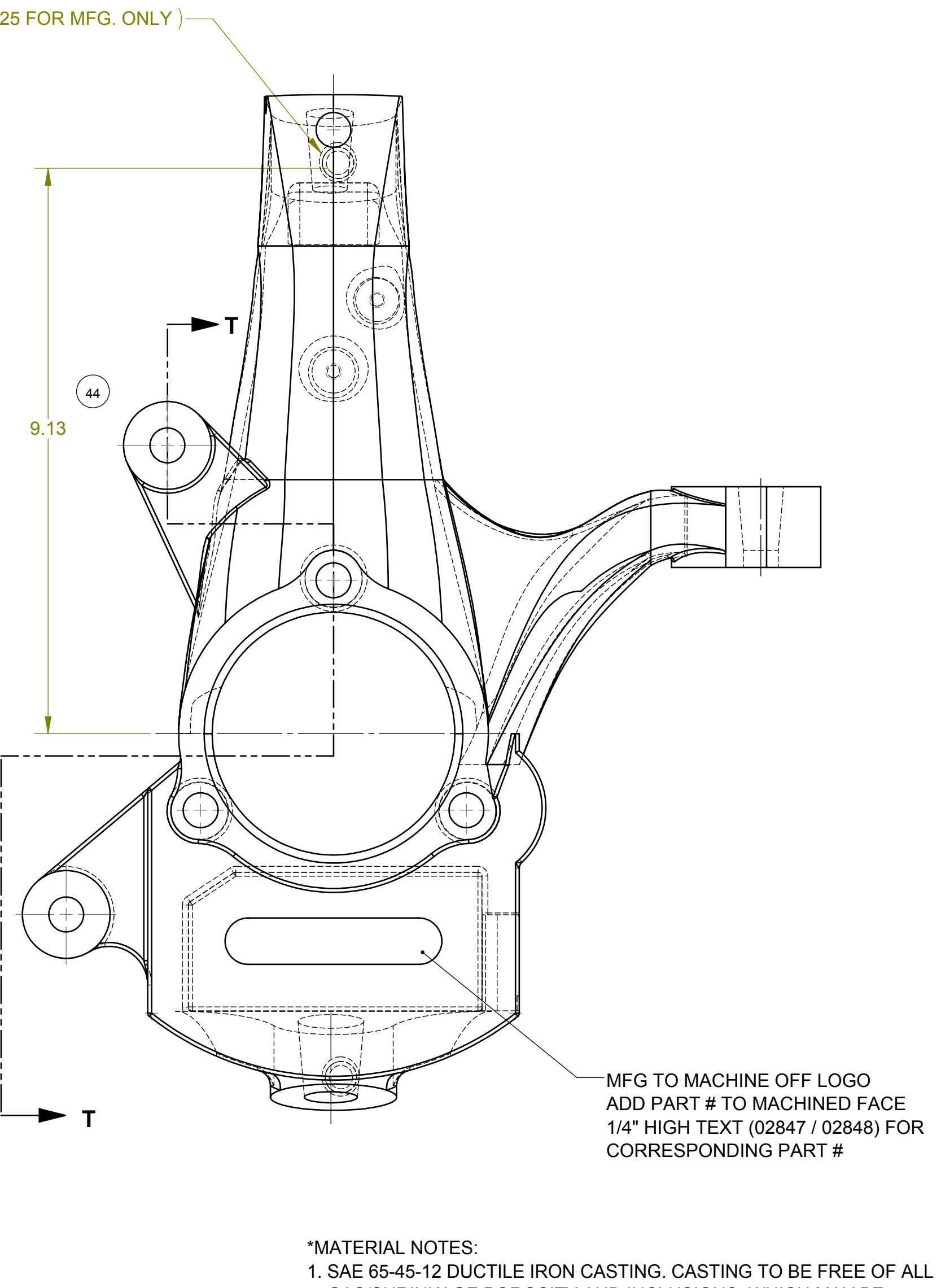
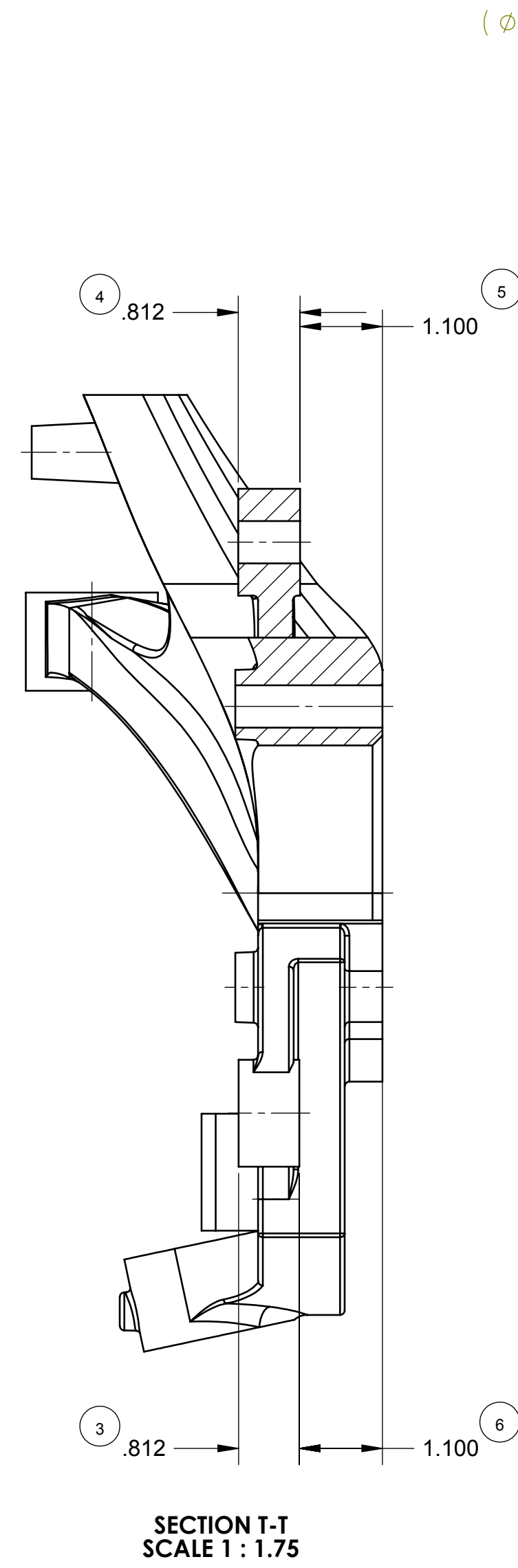
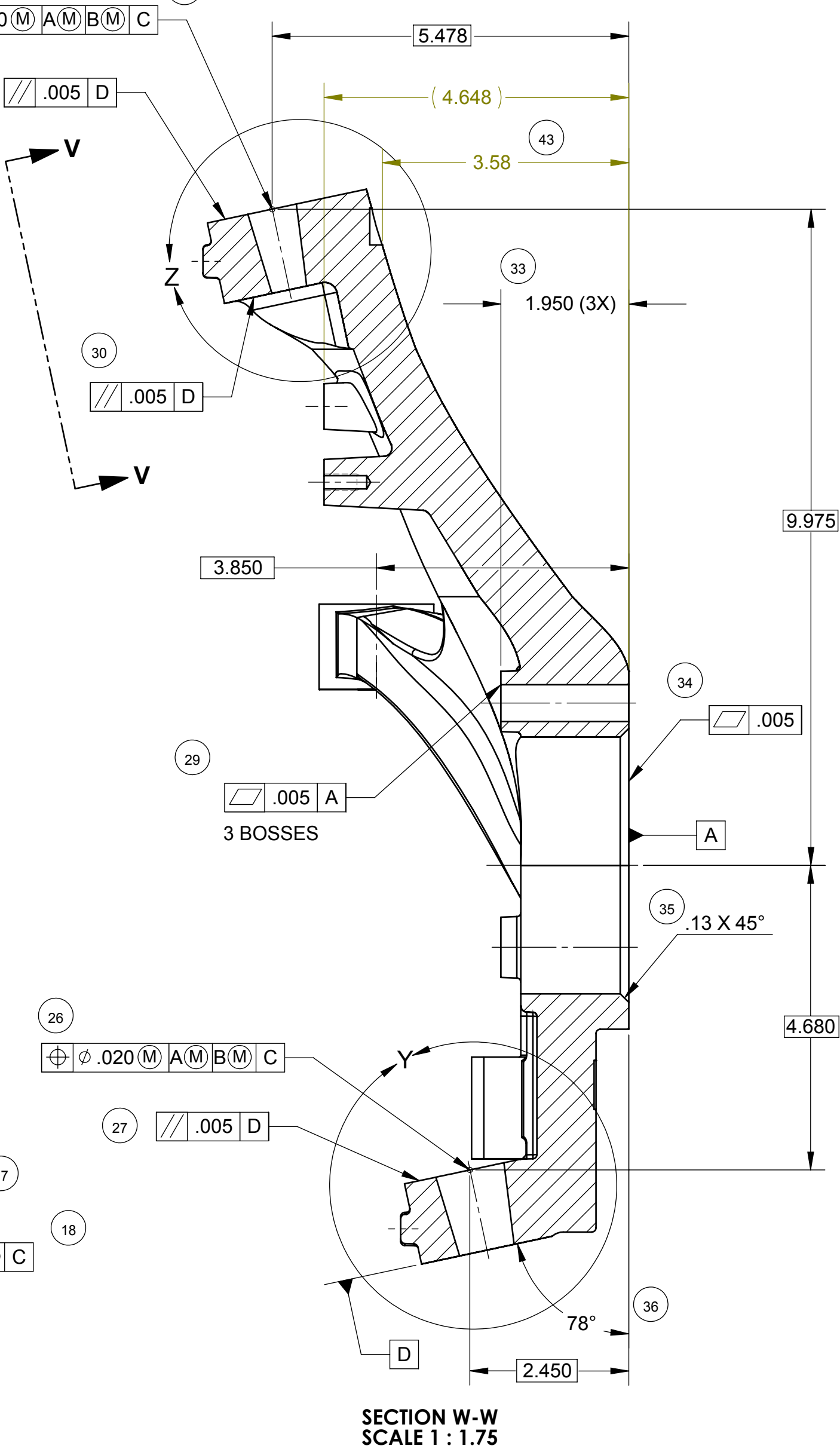
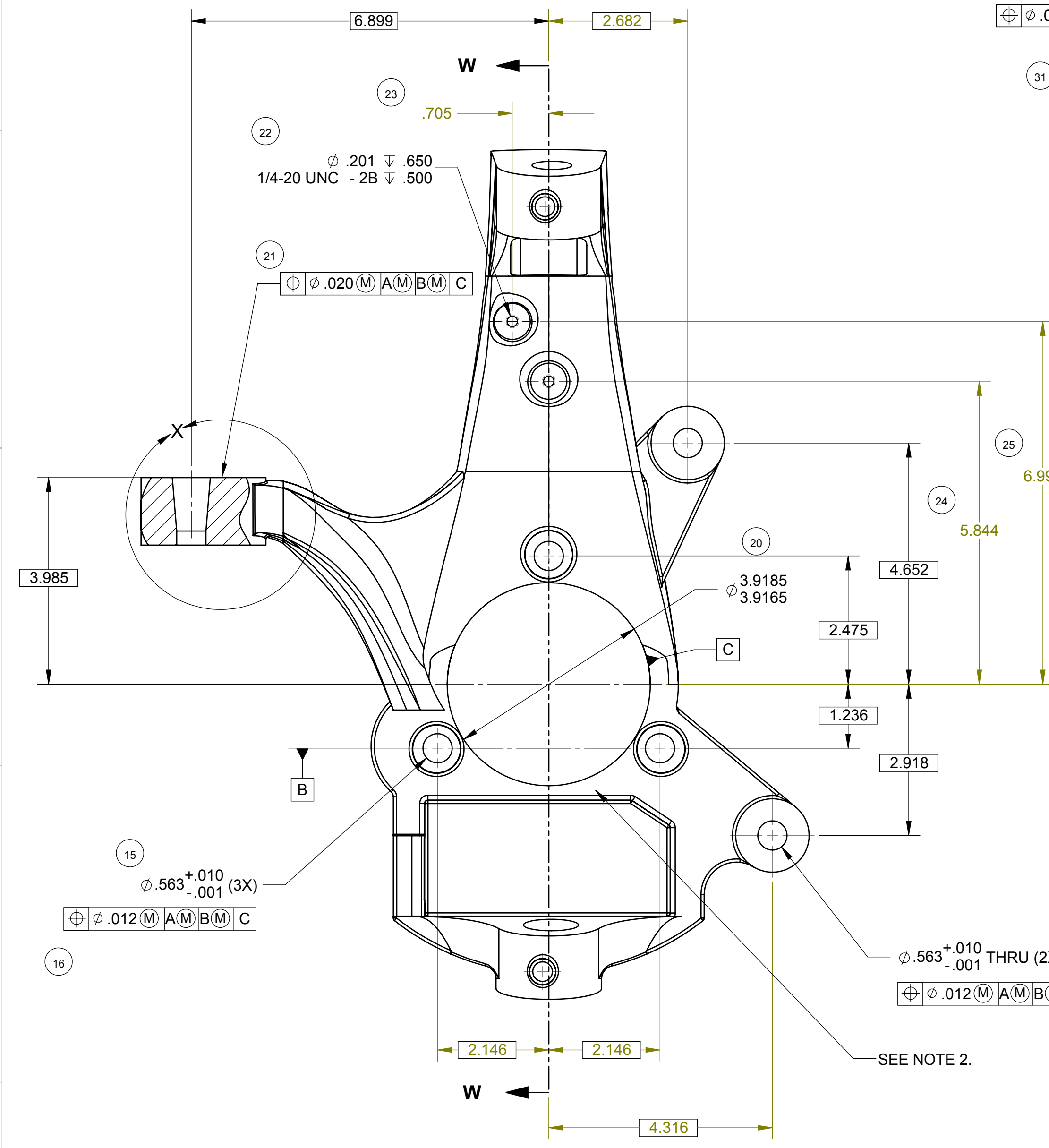
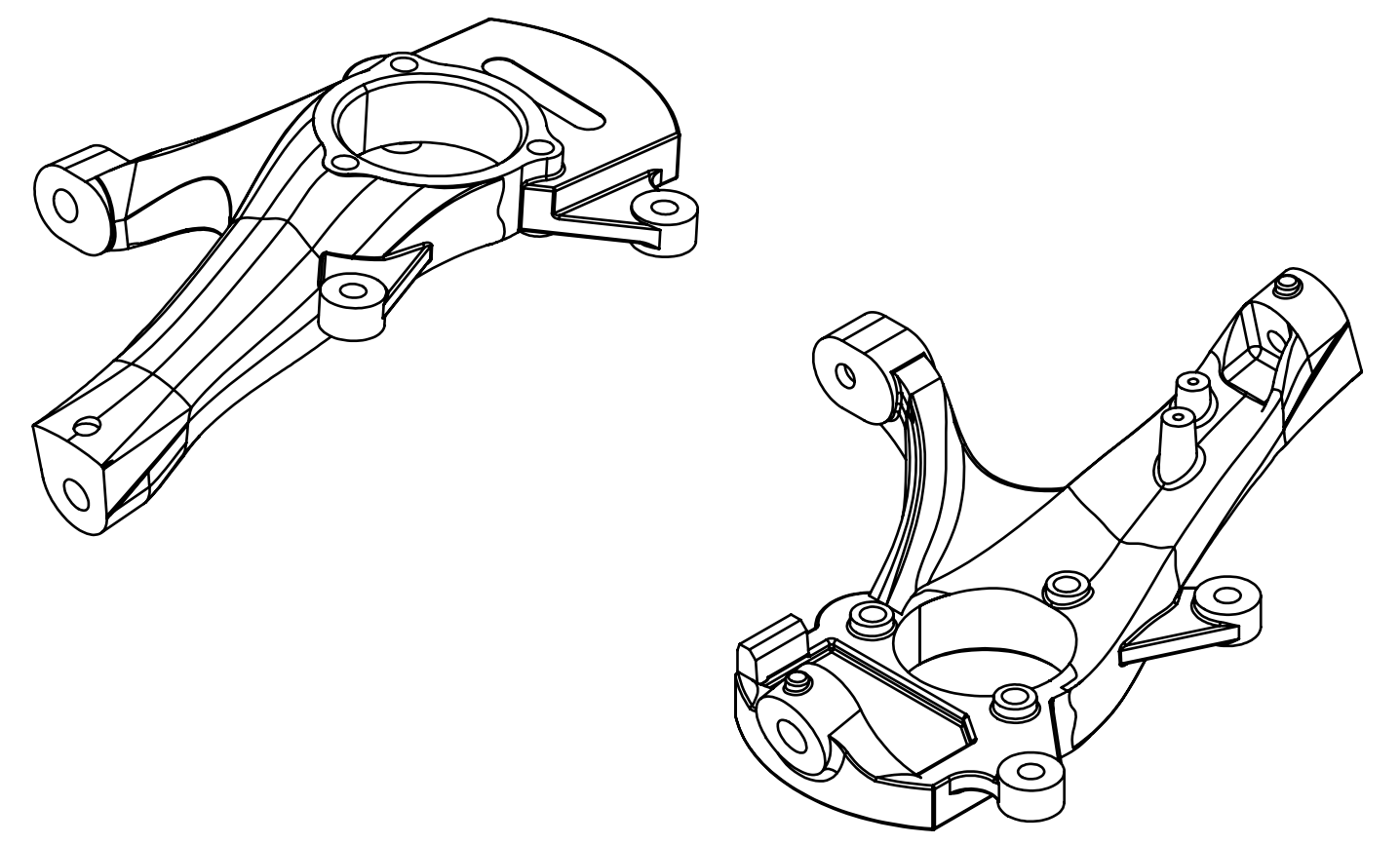
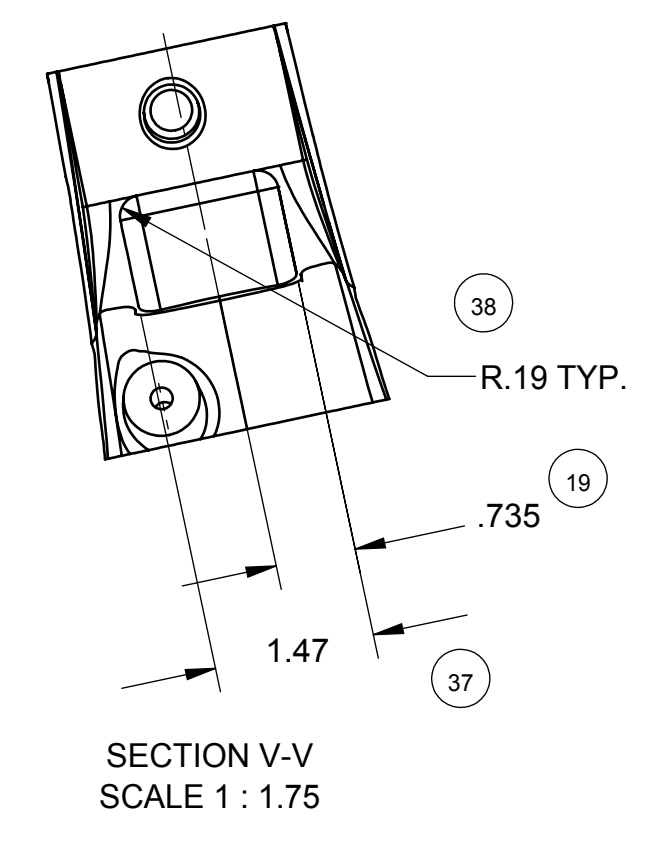
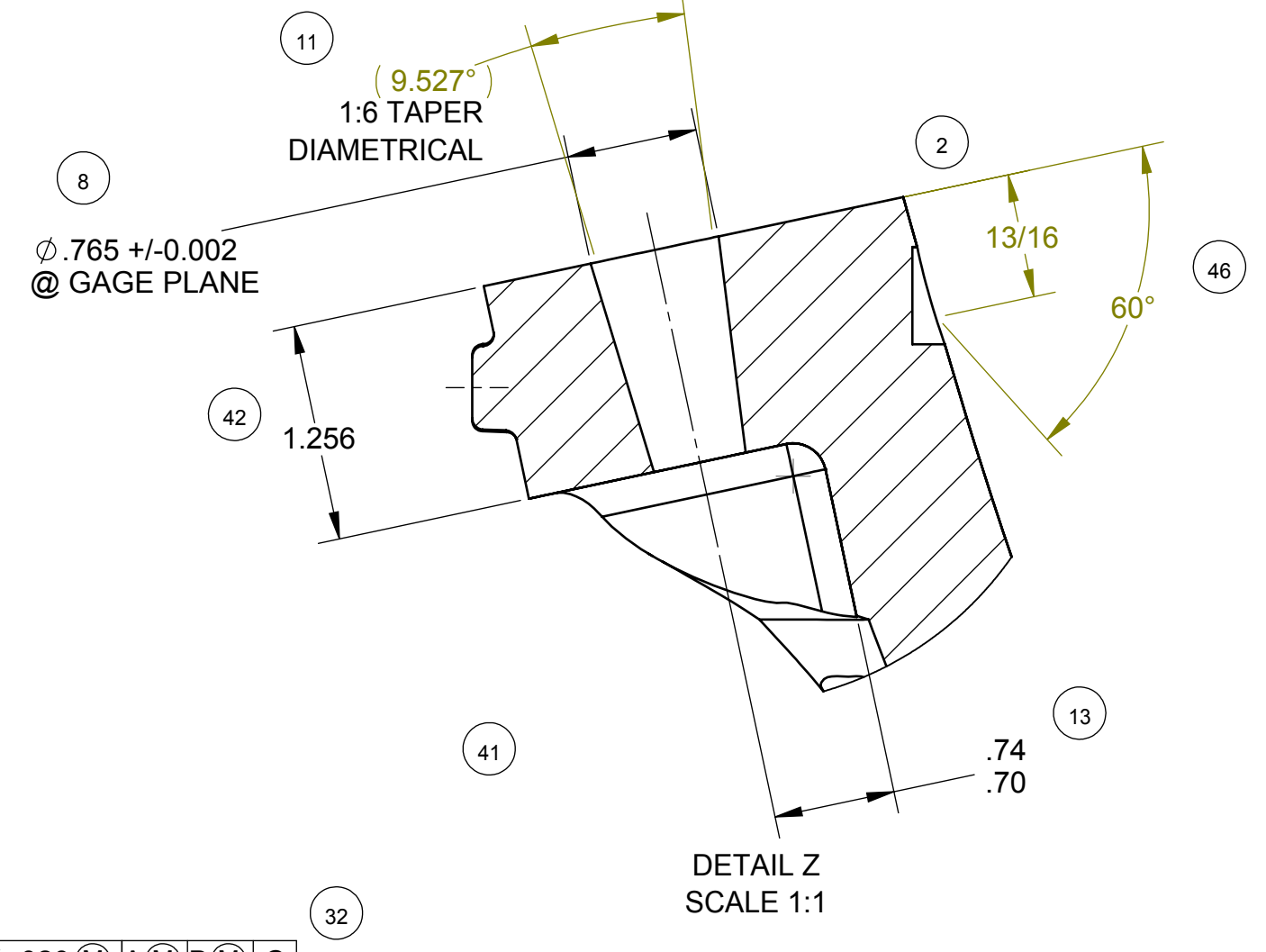
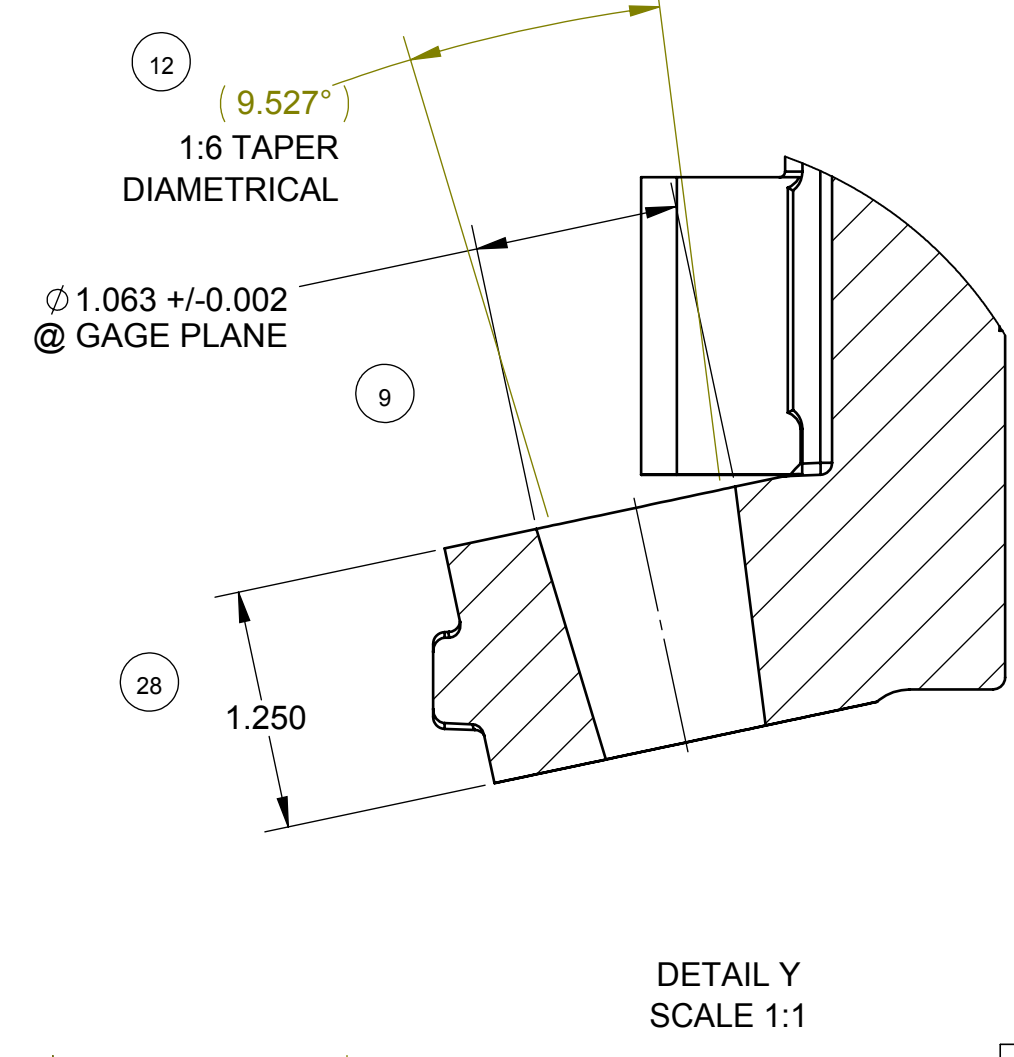
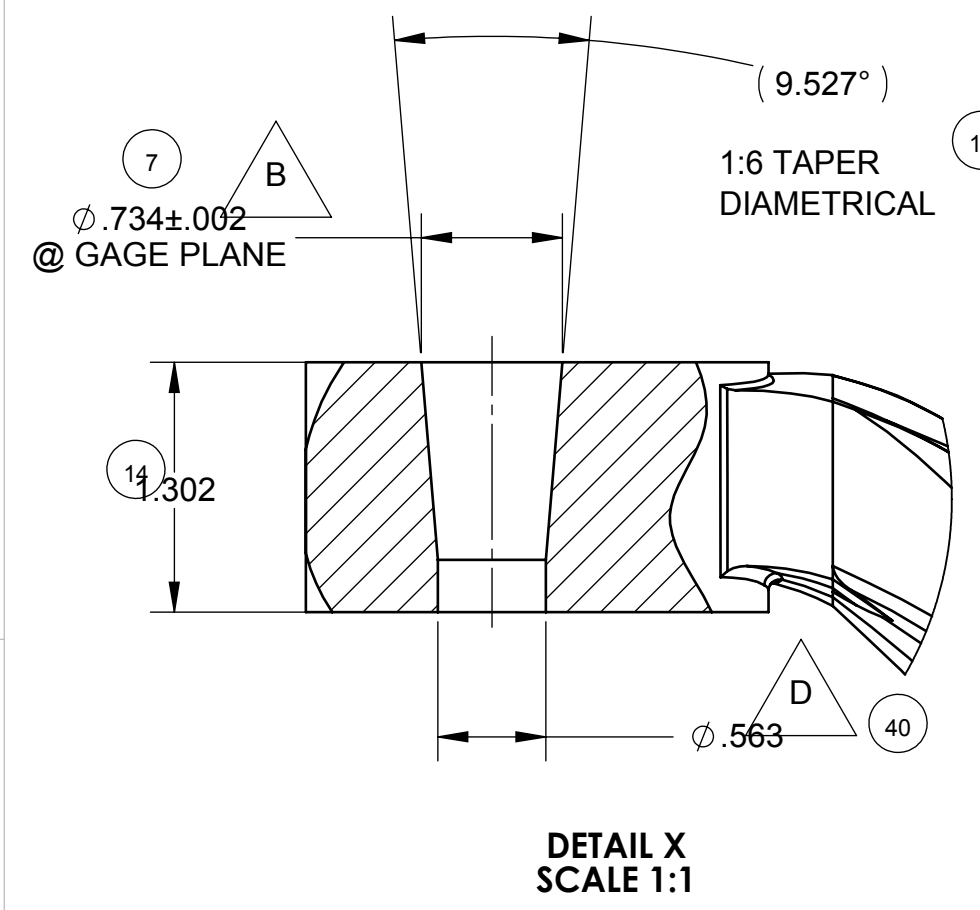

MFG TO MACHINE OFF LOGO
ADD PART # TO MACHINED FACE
1/4" HIGH TEXT (02847 / 02848) FOR
CORRESPONDING PART #

- NOTES:
1. TAPERED HOLES IN SECTION VIEWS "X", "Y", AND "Z" MUST EXHIBIT 60% AREA OF CONTACT WHEN CHECKED WITH A BLUED CONICAL MASTER PLUG. USE A GAGE WITH 1:6 OR 2" PER 12" DIAMETRICAL TAPER (9.527° INCLUDED CONE ANGLE). MACHINE FINISH TAPERS 63Ra MAXIMUM.
 2. VENDOR CODE AND CASTING DATE CODE/HEAT LOT TO APPEAR WHERE INDICATED.
 3. DIMENSIONS SHOWN IN PARENTHESIS ARE FOR REFERENCE ONLY.
 4. REMOVE ALL BURRS AND SHARP EDGES .020 MAX.

*MATERIAL NOTES:
1. SAE 65-45-12 DUCTILE IRON CASTING. CASTING TO BE FREE OF ALL GAS/SHRINKAGE POROSITY AND INCLUSIONS, WHICH MAY BE DETRIMENTAL TO STRENGTH OR FUNCTION OF THE PART.
2. REFER TO THE CAD MODEL (MATH DATA FILE) FOR CASTING DIMENSIONS AND DETAILS.

**RIGHT-HAND (PASSENGER-SIDE) 02848 SHOWN.
LEFT HAND (DRIVER-SIDE) IS PART NUMBER 02847 BDS,
AND IS A MIRROR IMAGE ABOUT THE VERTICAL AXIS.
DRAWING NUMBER 02847-02848**

UNLESS OTHERWISE NOTED: DIMENSIONS ARE IN INCHES		Property of BDS Suspension	
LINEAR TOL.:	.XX ± .020 .XXX ± .010 Frac. ± 1/32	104 S. Michigan Ave. Phone: 517-279-7404 Coldwater, MI 49036 Fax: 517-278-2316	
ANGULAR TOL.:	±0.5°	DRAWING NAME 2007 CHEVY TAHOE PASSENGER-SIDE STEERING KNUCKLE	
DRAWN BY	ME	SIZE	D
DATE	11/18/02	DWG NO.	02847-02848
APPROVED BY	GH	SCALE	1:1.75
		MATL.	SEE NOTE*
		SHEET	1 OF 1